

E-TYPE AISI 304 Stainless Steel: cylindrical anti-vibration male-male buffer

Cylindrical anti-vibration buffer with two seats composed of two AISI 304 stainless steel screws. These are pressed on washers, sandblasted and attached, and then vulcanised on high-quality natural rubber mix.

In stock in 55 Shore hardness. This article is available on request with different specifications, different screw sizes, Shore hardness and ground mix bases

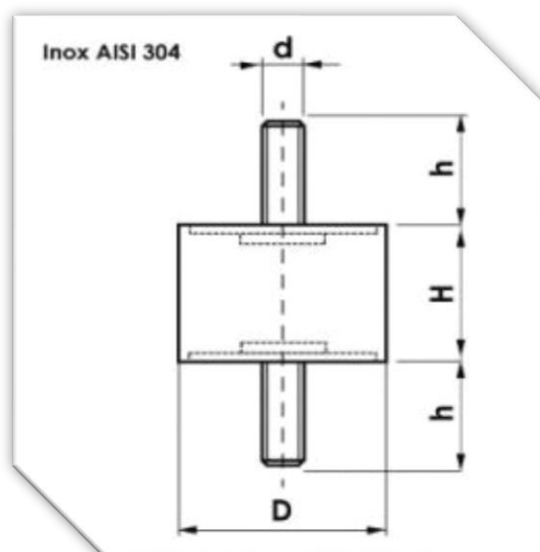

CODE	TYPE		DIMENSIONS	
	E inox		d	h
	D	H		
15x8	15	8	M4	10
15x10	15	10	M4	10
15x13,5				
15x15	15	15	M4	10
15x20	15	20	M4	10
15x30	15	30	M4	10
25x15				
25x20	25	20	M6	18
25x25	25	25	M6	18
25x30	25	30	M6	18
25x40	25	40	M6	18
30x10				
30x15				
30x20	30	20	M8	23
30x25	30	25	M8	23
30x30	30	30	M8	23
40x15				
40x20	40	20	M8	23
40x25	40	25	M8	23
40x30	40	30	M8	23
40x40	40	40	M8	23
40x50	40	50	M8	23

CODE	TYPE		DIMENSIONS	
	E inox		d	h
	D	H		
40x50	40	50	M8	23
50x20				
50x25	50	25	M10	28
50x30	50	30	M10	28
50x40	50	40	M10	28
50x50	50	50	M10	28
50x60	50	60	M10	28
60x20				
60x30	60	30	M10	28
60x40	60	40	M10	28
60x50	60	50	M10	28
75x25	75	25	M12	38
75x30	75	30	M12	38
75x40	75	40	M12	38
75x45	75	45	M12	38
75x50	75	50	M12	38
75x55	75	55	M12	38
80x40	80	40	M12	38
80x66	80	66	M12	38
100x40	100	40	M16	38
100x50	100	50	M16	38
100x80	100	80	M16	38